

200# WOG WAFER STYLE BUTTERFLY VALVE – Lever Handle

Figure: BW-4000 Series

Options:

Seats: Buna-N, EPDM, Hypalon, Viton, Neoprene, PTFE.

Disc: *Nickel Plated Ductile iron, Nylon 11 Encapsulated ductile iron, EPDM Encapsulated Ductile iron, Aluminum bronze, 304 & 316 Stainless steel.

Body: Cast iron, Ductile iron & Stainless steel.

Stem: 410SS, 416SS, 304SS, 316SS.

Note:

**All seats are a cartridge style with the "rubber" bonded to a phenolic backing ring for support.

Please refer to the Numbering System guide, 4000 series, to establish a figure number for ordering.

Note: Seat materials are capable of withstanding lower temperatures without damage. However, the elastomer becomes hard and torques increase. Some flow media may further restrict the published temperature limits and/or significantly reduce seat life.

Temperature range of seats	
Material	Range
Buna-N	-12°C ~ +93°C
EPDM	-30°C ~ +140°C
Neoprene	-7°C ~ +107°C
Hypalon	-18°C ~ +149°C
Viton	-12°C ~ +140°C
PTFE	-20°C ~ +121°C

Size		do	K
in	mm	mm	mm
2	50	12.6±0.025	10
2½	65	12.6±0.025	10
3	80	12.6±0.025	10
4	100	15.77±0.025	12
5	125	18.92±0.025	14
6	150	18.92±0.025	14
8	200	22.10±0.025	17
10	250	28.45±0.025	22
12	300	31.60±0.051	24



Valves meet MSS-SP67 & API 609

Flange drilling to: ANSI B16.1 Class 125/150

Testing to: API 598

Materials:

No.	Part Name	Specifications
1	Body	A126 Class B Cast Iron
2	Bushing (long)	PTFE
3	Seat **	Buna-N
4	Disc	A 536 Ductile Iron*
5	Stem	A433 410 Stainless Steel
6	Bushing (short)	PTFE
7	O-Ring	Buna-N
8	Spring pin	65 Mn Carbon steel
9	Grease fitting	B16 Brass

*Nickel plated

Test Pressures	Shell: 300 psi
	Seat: 220 psi

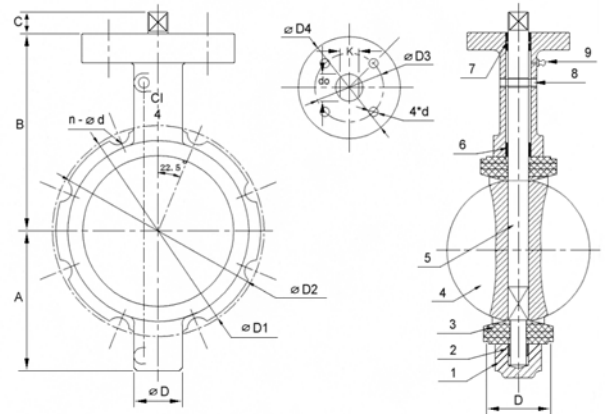

Dimensions:

Size		D		ØD		A		B		C		Flange					ØD3		ØD4		4*d		Weight	
												ØD1		ØD2		n-Ød								
in	mm	in	mm	in	mm	in	mm	in	mm	in	mm	in	mm	in	mm	in	mm	in	mm	in	mm	lb	kg	
2	50	1.65	42	1.38	36	2.87	73	3.94	100	1.26	32	4.75	120.6	4.13	105	4 - ¾"	2.76	70	3.54	90	.39	10	7.7	3.5
2½	65	1.77	45	1.38	36	3.13	79.5	4.47	113.5	1.26	32	5.5	139.7	4.92	125	4 - ¾"	2.76	70	3.54	90	.39	10	8.8	4.0
3	80	1.78	45.2	1.38	36	3.43	87	4.86	123.5	1.26	32	6.0	152.4	5.39	137	4 - ¾"	2.76	70	3.54	90	.39	10	9.24	4.2
4	100	2.05	52	1.57	40	4.04	102.5	5.98	152	1.26	32	7.5	190.5	7.01	178	8 - ¾"	2.76	70	3.54	90	.39	10	12.3	5.69
5	125	2.19	55.5	1.61	41	4.27	108.4	5.87	149	1.26	32	8.5	215.9	7.59	192.7	8 - ⅞"	2.76	70	3.54	90	.39	10	13.2	6.0
6	150	2.19	55.75	1.77	45	5.12	130	6.54	166	1.26	32	9.5	241.3	8.82	224	8 - ⅞"	2.76	70	3.54	90	.39	10	18.7	8.5
8	200	2.39	60.58	1.90	48	6.22	158	8.03	204	1.57	40	11.76	298.4	11.1	282	8 - ⅞"	4.02	102	4.92	125	.47	12	30.8	14.0
10	250	2.68	68	2.09	53	7.57	192.2	10.15	257.8	1.57	40	14.25	361.9	13.3	338.4	12 – 1"	4.02	102	4.92	125	.47	12	50.6	23.0
12	300	3.02	76.8	2.16	55	9.59	243.6	10.96	278.4	1.57	40	17.0	431.8	16.6	422.4	12 – 1"	4.02	102	4.92	125	.47	12	71.5	32.5